

SIDE ELEVATION - 3 Panels - 150'-0" Over-All Dimension for Skidmore
 7 Panels - 112'-8" Over-All Dimension for Gregory

HALF END ELEVATION - HALF SECTION A-A

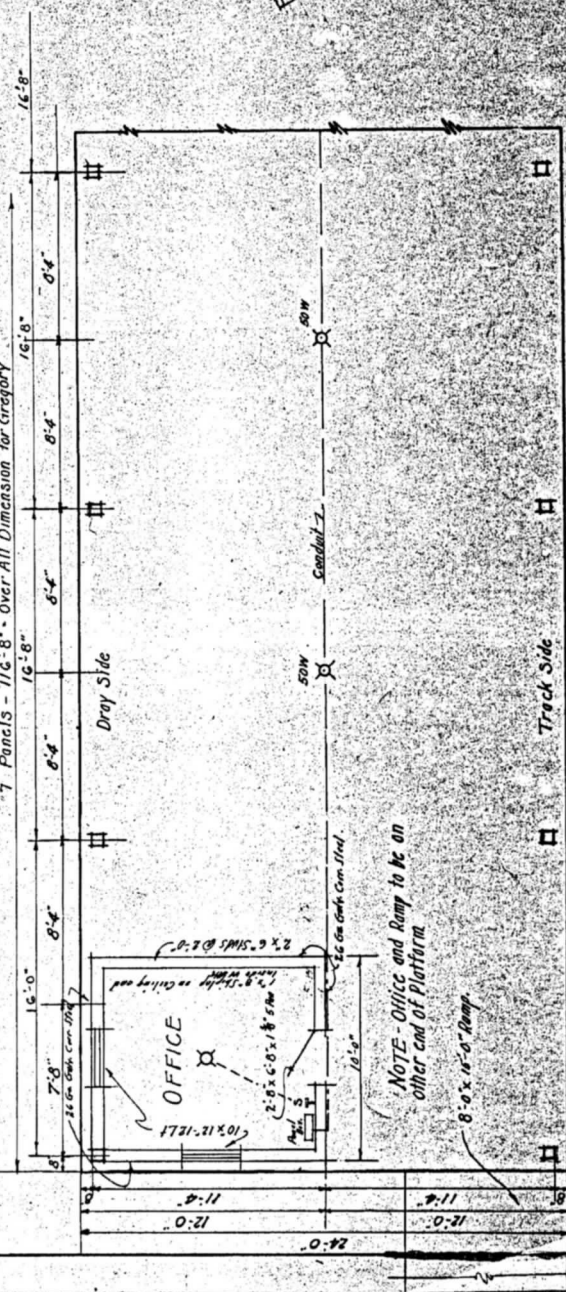

FLOOR PLAN

EXISTING GREGORY SHED

SOUTHERN PACIFIC LINES
 IN
 TEXAS AND LOUISIANA
 DETAIL OF 24'-0" X 120'-0" COTTON PLATFORM
 Office of Chief Engineer GREGORY
 Houston, Texas
 April 14, 1933
 24'-0" X 120'-0" FOR SKIDMORE